

# TISCHPLAN

30 PERSONEN EXKLUSIV

**GOLDMAN**  
RESTAURANT

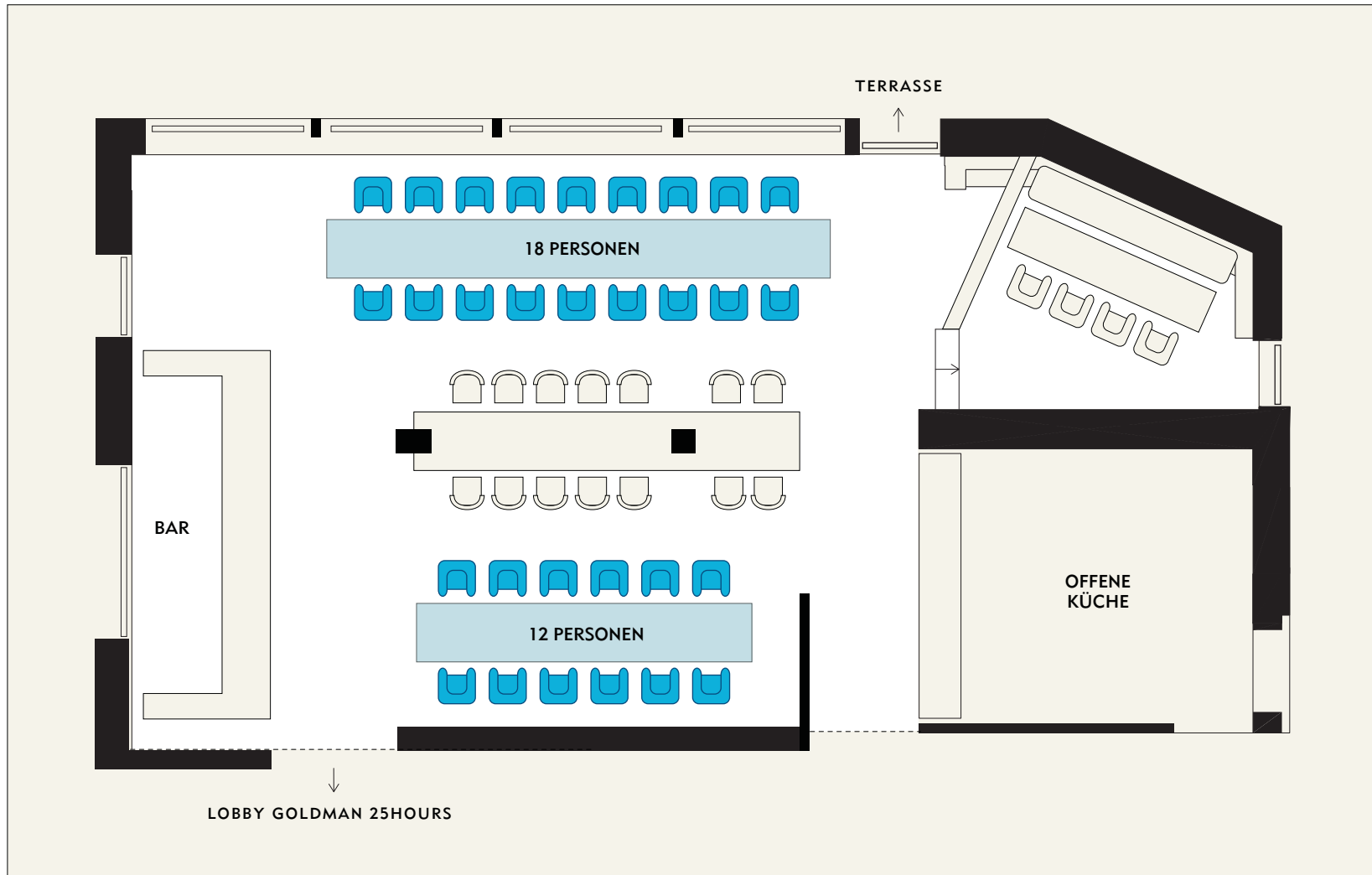

# TISCHPLAN

30 PERSONEN

**GOLDMAN**  
RESTAURANT

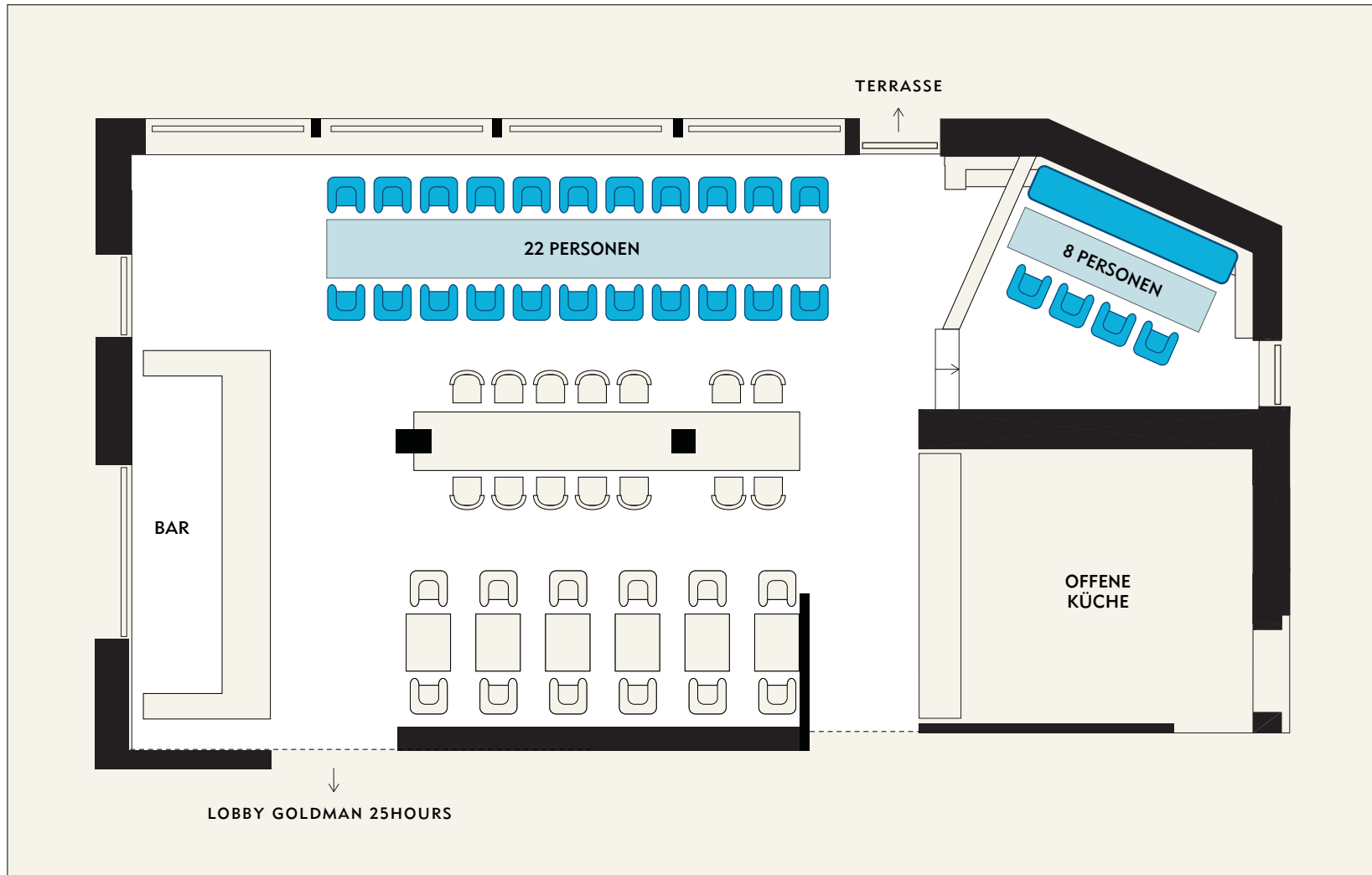

# TISCHPLAN

40 PERSONEN - EXKLUSIV

**GOLDMAN**  
RESTAURANT

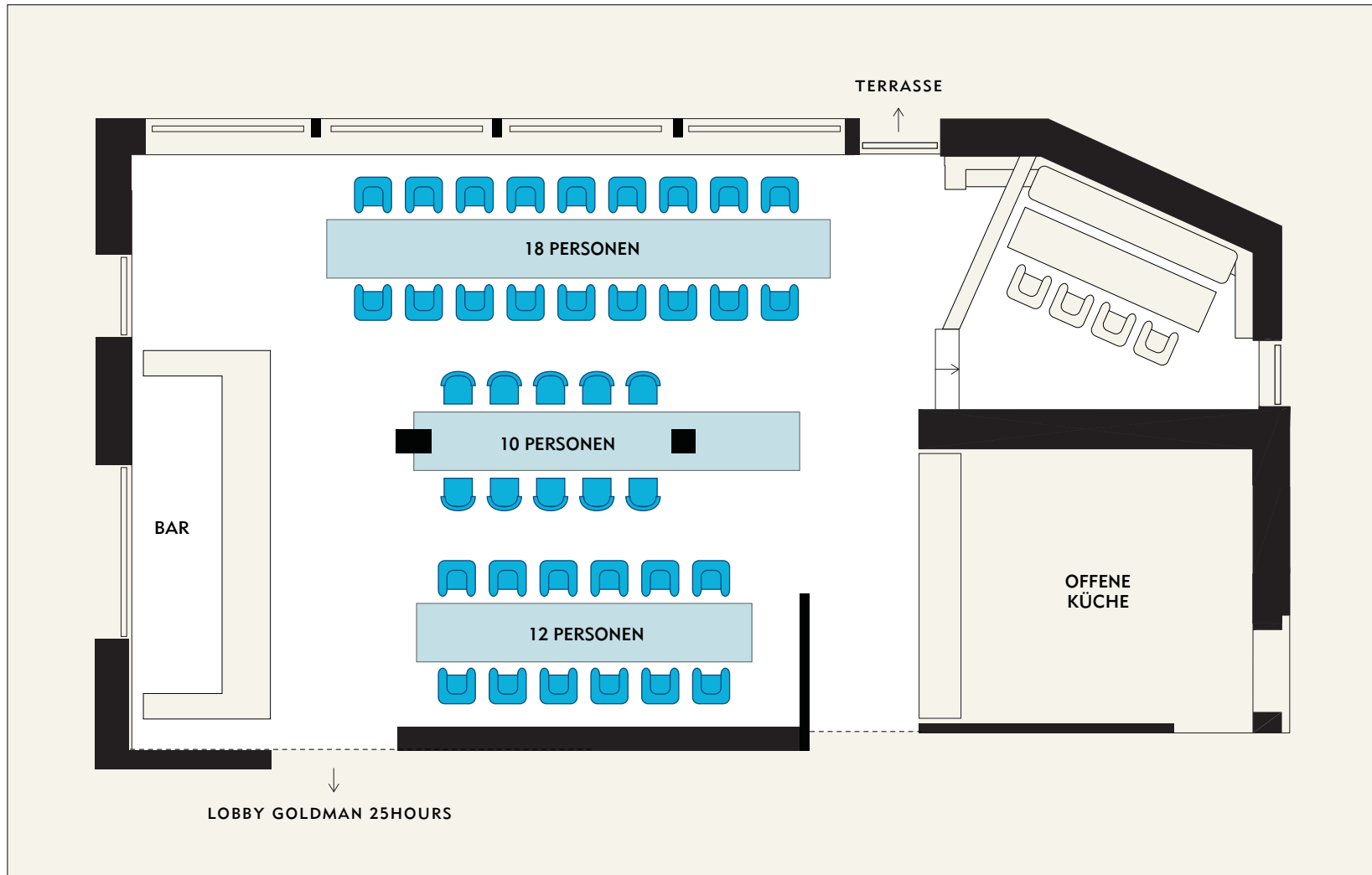

# TISCHPLAN

40 PERSONEN

**GOLDMAN**  
RESTAURANT

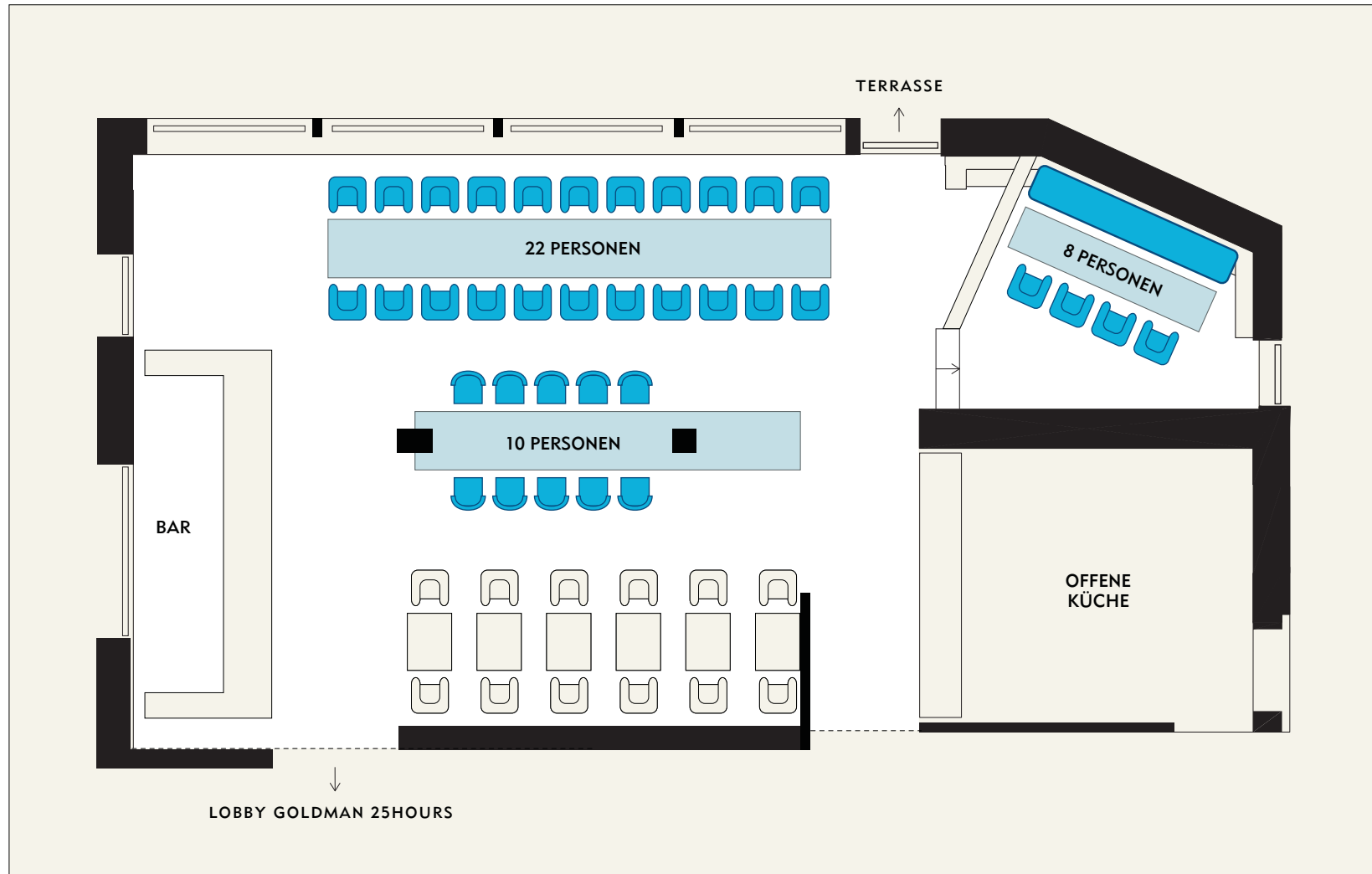

# TISCHPLAN

50 PERSONEN EXKLUSIV

**GOLDMAN**  
RESTAURANT

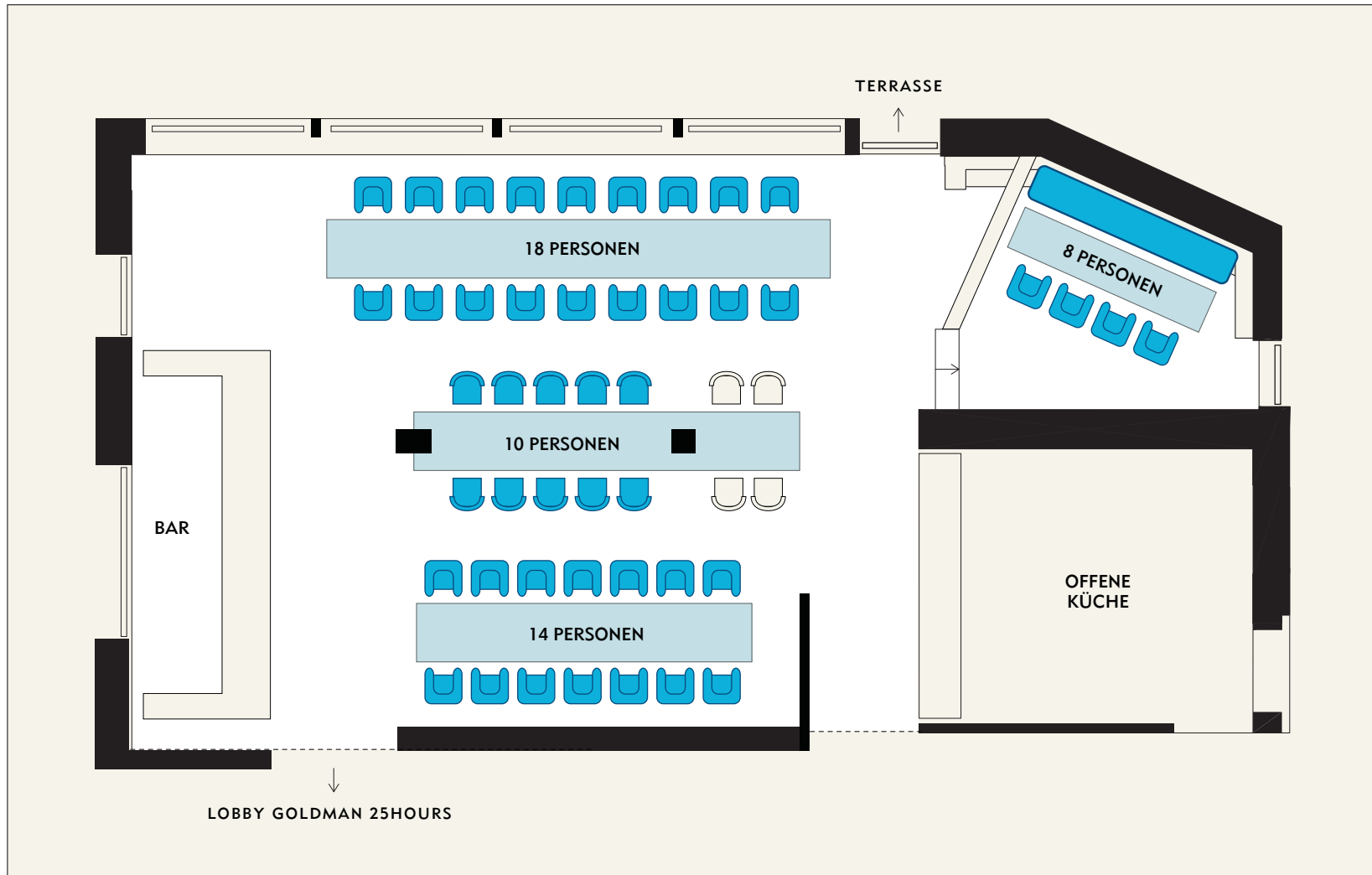

# TISCHPLAN

59 PERSONEN EXKLUSIV

**GOLDMAN**  
RESTAURANT

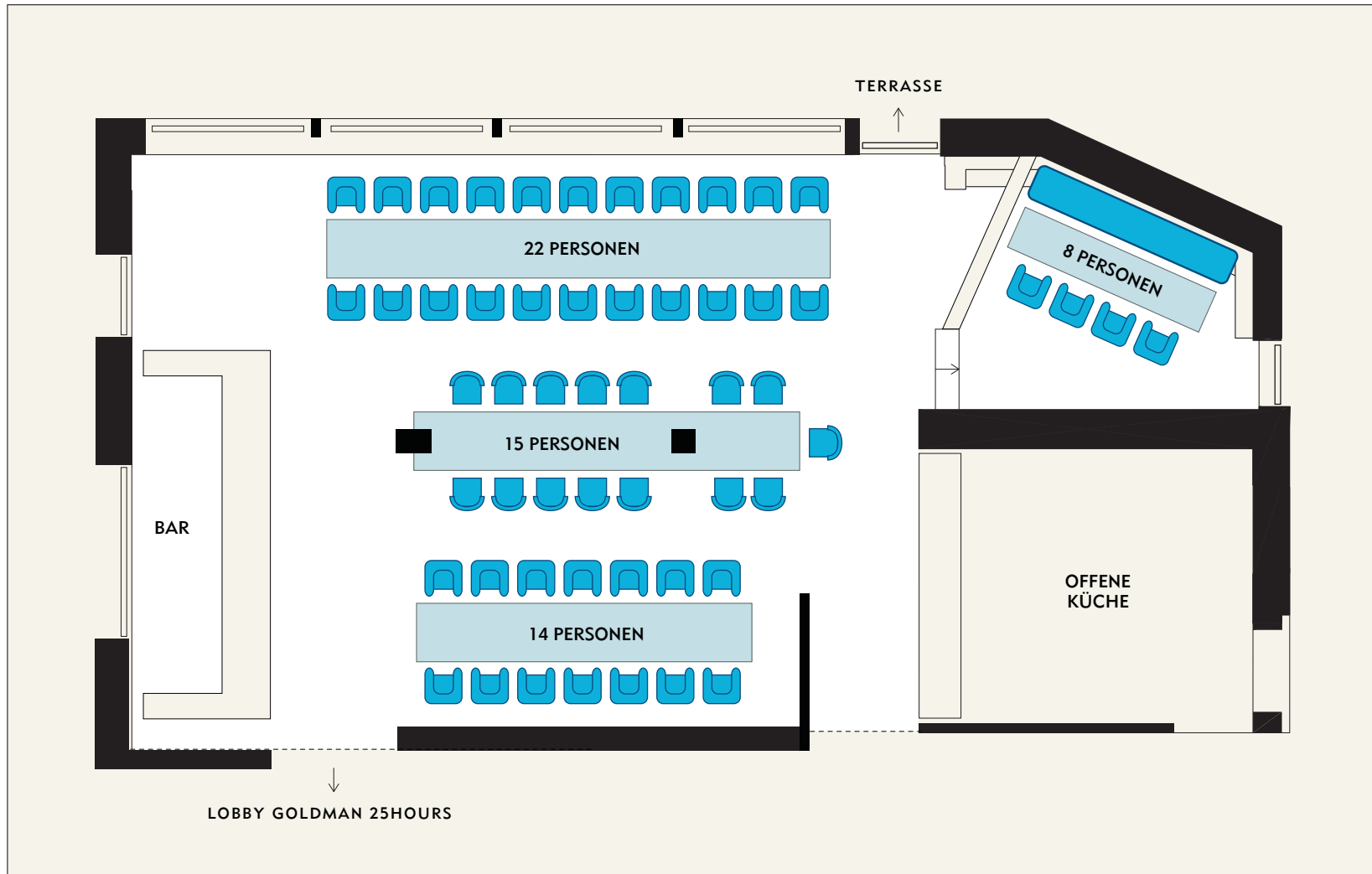

# TISCHPLAN

À la carte - Bestuhlung

**GOLDMAN**  
RESTAURANT

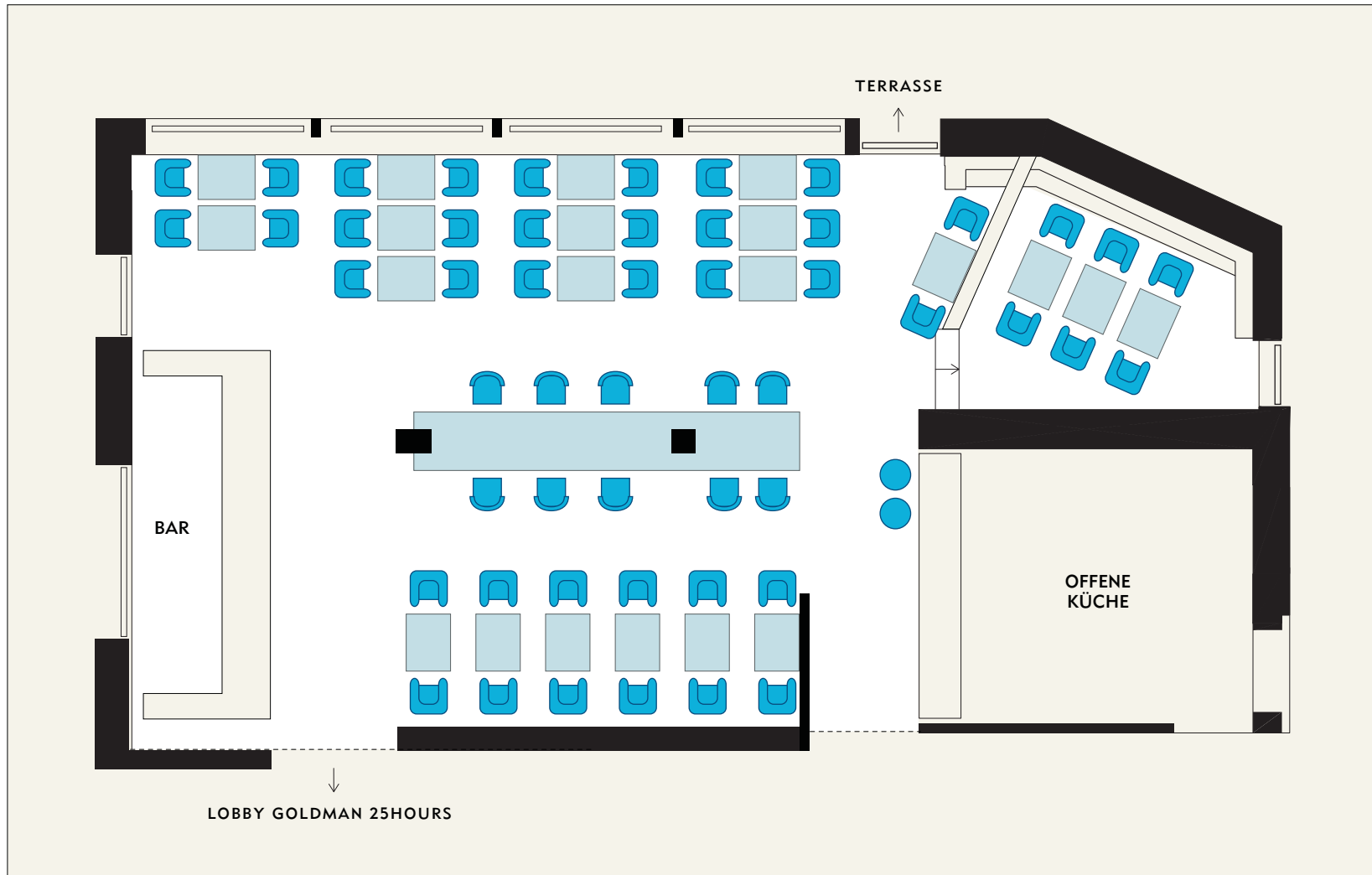

# TISCHPLAN

Möglichkeiten - bis zu 65 Personen

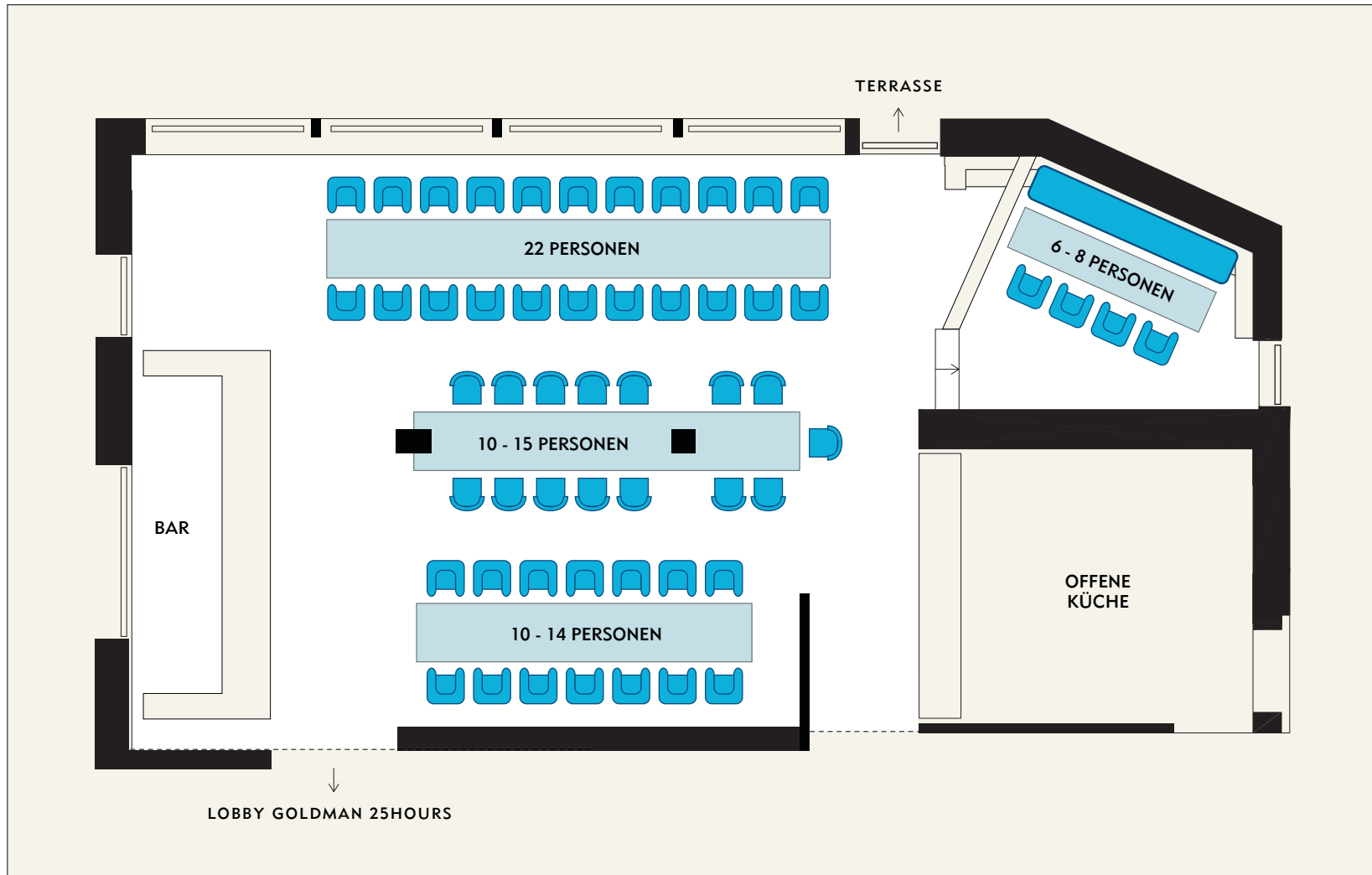

# TISCHPLAN

Wohnzimmer - bis zu 22 Personen

**GOLDMAN**  
RESTAURANT

